

FOCAL LENGTH (EFL): $36 \pm 0,36$
 BACK FOCAL LENGTH (BFL): $34,59$

- 1 AR COATING: YAG-BBAR
 $R(\text{ABS}) < 0,25\% @ 532\text{nm} @ 0^\circ \text{AOI}$
 $R(\text{ABS}) < 0,25\% @ 1064\text{nm} @ 0^\circ \text{AOI}$
 $R(\text{AVG}) < 1,0\% \text{ FROM } 500\text{-}1100\text{nm} @ 0^\circ \text{AOI}$
- 2 BLACKENED SURFACE

LEFT SURFACE		MATERIAL	RIGHT SURFACE	
R	$36,6 \pm 0,037 \text{ CX}$	GLASS N-BK7 517/642	R	$36,6 \pm 0,037 \text{ CX}$
Øe	17		Øe	17
3/	3 (0,5) $\lambda=632,8 \text{ nm}$		3/	3 (0,5) $\lambda=632,8 \text{ nm}$
4/	-		4/	1,93'
5/	40 - 20 (MIL-PRF-13830B)		5/	40 - 20 (MIL-PRF-13830B)
6/	-		6/	-

PROTECTIVE CHAMFERS AS NEEDED

ROHS: COMPLIANT
 SCALE: NONE $\lambda = 587,6\text{nm}$

SPECIFICATIONS SUBJECT TO CHANGE WITHOUT NOTICE. DIMENSIONS ARE FOR REFERENCE ONLY

FOR INFORMATION ONLY: DO NOT MANUFACTURE PARTS TO THIS DRAWING

INDICATIONS IN ACCORDANCE WITH ISO 10110

FIRST ANGLE PROJECTION

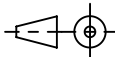

ALL DIMS IN: mm



Edmund Optics®

TITLE

18mm Dia, x 36mm FL, YAG-BBAR Coated, Inked, Double-Convex Lens

DWG NO

892561NK

SHEET SIZE
A4

SHEET
1 OF 1