

FOCAL LENGTH (EFL): 90 ± 0,9

BACK FOCAL LENGTH (BFL): 88,68

- 1 AR COATING: VIS-EXT
R(AVG) ≤ 0,5% FROM 350-700nm @ 0° AOI
- 2 BLACKENED SURFACE

LEFT SURFACE		MATERIAL	RIGHT SURFACE	
R	46,51±0,047 CX	GLASS N-BK7 517/642	R	∞ PL
Øe	8,1		Øe	8,1
3/	3 (0,5) λ=632,8 nm		3/	3 (0,5) λ=632,8 nm
4/	-		4/	1,93'
5/	40 - 20 (MIL-PRF-13830B)		5/	40 - 20 (MIL-PRF-13830B)
6/	-		6/	-

PROTECTIVE CHAMFERS AS NEEDED

ROHS: COMPLIANT SCALE: NONE λ = 587,6nm

SPECIFICATIONS SUBJECT TO CHANGE WITHOUT NOTICE. DIMENSIONS ARE FOR REFERENCE ONLY

FOR INFORMATION ONLY: DO NOT MANUFACTURE PARTS TO THIS DRAWING

INDICATIONS IN ACCORDANCE WITH ISO 10110

FIRST ANGLE PROJECTION

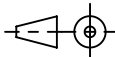

ALL DIMS IN: mm



Edmund Optics®

TITLE 9,0mm Dia, x 90,0mm FL, VIS-EXT, Inked, Plano-Convex Lens

DWG NO 886611NK

SHEET SIZE A4

SHEET 1 OF 1