

FOCAL LENGTH (EFL): $-9 \pm 0,09$

BACK FOCAL LENGTH (BFL): $-10,21$

1 AR COATING: NIR I
 $R(\text{AVG}) \leq 0,5\%$ FROM 600-1050nm @ 0° AOI

LEFT SURFACE		MATERIAL	RIGHT SURFACE	
R	7,07±0,007 CV	GLASS N-SF11 785/258	R	∞ PL
Øe	8,1		Øe	8,1
3/	3 (0,5) $\lambda=632,8$ nm		3/	3 (0,5) $\lambda=632,8$ nm
4/	-		4/	3,82'
5/	40 - 20 (MIL-PRF-13830B)		5/	40 - 20 (MIL-PRF-13830B)
6/	-		6/	-

PROTECTIVE CHAMFERS AS NEEDED

ROHS: COMPLIANT SCALE: NONE $\lambda = 587,6\text{nm}$

SPECIFICATIONS SUBJECT TO CHANGE WITHOUT NOTICE. DIMENSIONS ARE FOR REFERENCE ONLY

FOR INFORMATION ONLY: DO NOT MANUFACTURE PARTS TO THIS DRAWING

INDICATIONS IN ACCORDANCE WITH ISO 10110

FIRST ANGLE PROJECTION

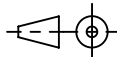

ALL DIMS IN: mm



Edmund Optics®

TITLE

9,0mm Diameter x -9 FL, NIR I Coated, Plano-Concave Lens

DWG NO

49521

SHEET SIZE
A4

SHEET
1 OF 1