

FOCAL LENGTH (EFL): 100 ± 1

BACK FOCAL LENGTH (BFL): 98,02

- 1 AR COATING: NIR I
R(AVG) ≤ 0,5% FROM 600-1050nm @ 0° AOI
- 2 BLACKENED SURFACE

LEFT SURFACE		MATERIAL	RIGHT SURFACE	
R	51,68±0,052 CX	GLASS N-BK7 517/642	R	∞ PL
Øe	14		Øe	14
3/	3 (0,5) λ=632,8 nm		3/	3 (0,5) λ=632,8 nm
4/	-		4/	1,93'
5/	40 - 20 (MIL-PRF-13830B)		5/	40 - 20 (MIL-PRF-13830B)
6/	-		6/	-

PROTECTIVE CHAMFERS AS NEEDED

ROHS: COMPLIANT SCALE: NONE λ = 587,6nm

SPECIFICATIONS SUBJECT TO CHANGE WITHOUT NOTICE. DIMENSIONS ARE FOR REFERENCE ONLY

FOR INFORMATION ONLY: DO NOT MANUFACTURE PARTS TO THIS DRAWING

INDICATIONS IN ACCORDANCE WITH ISO 10110

FIRST ANGLE PROJECTION

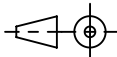

ALL DIMS IN: mm

EO® Edmund Optics®

TITLE 15,0mm Dia, x 100,0mm FL, NIR I, Inked, Plano-Convex Lens

DWG NO 487511NK

SHEET SIZE A4 SHEET 1 OF 1