

FOCAL LENGTH (EFL): $-24 \pm 0,24$
 BACK FOCAL LENGTH (BFL): $-24,65$

- 1 AR COATING: VIS-NIR
 $R(\text{ABS}) \leq 0,25\%$ AT 880nm @ 0° AOI
 $R(\text{AVG}) \leq 1,25\%$ FROM 400-870nm @ 0° AOI
 $R(\text{AVG}) \leq 1,25\%$ FROM 890-1000nm @ 0° AOI
- 2 BLACKENED SURFACE

LEFT SURFACE		MATERIAL	RIGHT SURFACE	
R	25,142±0,025 CV	GLASS N-BK7 517/642	R	25,142±0,025 CV
Øe	11		Øe	11
3/	3 (0,5) λ=632,8 nm		3/	3 (0,5) λ=632,8 nm
4/	-		4/	1,93'
5/	40 - 20 (MIL-PRF-13830B)		5/	40 - 20 (MIL-PRF-13830B)
6/	-		6/	-

PROTECTIVE CHAMFERS AS NEEDED

ROHS: COMPLIANT SCALE: NONE λ = 587,6nm

SPECIFICATIONS SUBJECT TO CHANGE WITHOUT NOTICE. DIMENSIONS ARE FOR REFERENCE ONLY

FOR INFORMATION ONLY: DO NOT MANUFACTURE PARTS TO THIS DRAWING

INDICATIONS IN ACCORDANCE WITH ISO 10110

FIRST ANGLE PROJECTION

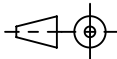

ALL DIMS IN: mm



Edmund Optics®

TITLE

12mm Dia, x -24mm FL, VIS-NIR, Inked, Double-Concave Lens

DWG NO

487011NK

SHEET SIZE
A4

SHEET
1 OF 1