

FOCAL LENGTH (EFL):  $-50 \pm 0,5$   
 BACK FOCAL LENGTH (BFL):  $-52,31$

1 AR COATING:

$\frac{1}{4}$  WAVE MgF2 @ 550nm  
 R(AVG) < 1,75% FROM 400-700nm (N-BK7)

LEFT SURFACE		MATERIAL	RIGHT SURFACE	
R	25,84±0,026 CV	GLASS N-BK7 517/642	R	$\infty$ PL
Øe	24		Øe	24
3/	3 (0,5) $\lambda=632,8$ nm		3/	3 (0,5) $\lambda=632,8$ nm
4/	-		4/	1,93'
5/	40 - 20 (MIL-PRF-13830B)		5/	40 - 20 (MIL-PRF-13830B)
6/	-		6/	-

PROTECTIVE CHAMFERS AS NEEDED

ROHS: COMPLIANT    SCALE: NONE     $\lambda = 587,6$ nm

SPECIFICATIONS SUBJECT TO CHANGE WITHOUT NOTICE. DIMENSIONS ARE FOR REFERENCE ONLY

FOR INFORMATION ONLY: DO NOT MANUFACTURE PARTS TO THIS DRAWING

INDICATIONS IN ACCORDANCE WITH ISO 10110

FIRST ANGLE PROJECTION

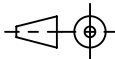

ALL DIMS IN: mm

**EO**® Edmund Optics®

TITLE 25,0mm Diameter x -50 FL, MgF2 Coated, Plano-Concave Lens

DWG NO 45029

SHEET SIZE A4 SHEET 1 OF 1