

FOCAL LENGTH (EFL):  $20 \pm 0,2$   
 BACK FOCAL LENGTH (BFL): 18,548

- 1 AR COATING: NIR II  
 $R(\text{ABS}) \leq 1,5\%$  FROM 750-800nm @  $0^\circ$  AOI  
 $R(\text{ABS}) \leq 1,0\%$  FROM 800-1550nm @  $0^\circ$  AOI  
 $R(\text{AVG}) \leq 0,7\%$  FROM 750-1550nm @  $0^\circ$  AOI
- 2 BLACKENED SURFACE

LEFT SURFACE		MATERIAL	RIGHT SURFACE	
R	10,335±0,01 CX	GLASS N-BK7 517/642	R	$\infty$ PL
Øe	8,1		Øe	8,1
3/	3 (0,5) $\lambda=632,8$ nm		3/	3 (0,5) $\lambda=632,8$ nm
4/	-		4/	1,93'
5/	40 - 20 (MIL-PRF-13830B)		5/	40 - 20 (MIL-PRF-13830B)
6/	-		6/	-

PROTECTIVE CHAMFERS AS NEEDED

ROHS: COMPLIANT    SCALE: NONE     $\lambda = 587,6$ nm

SPECIFICATIONS SUBJECT TO CHANGE WITHOUT NOTICE. DIMENSIONS ARE FOR REFERENCE ONLY

FOR INFORMATION ONLY: DO NOT MANUFACTURE PARTS TO THIS DRAWING

INDICATIONS IN ACCORDANCE WITH ISO 10110

FIRST ANGLE PROJECTION

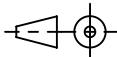

ALL DIMS IN: mm

**EO**® Edmund Optics®

TITLE 9,0mm Dia, x 20,0mm FL, NIR II, Inked, Plano-Convex Lens

DWG NO 383901NK

SHEET SIZE A4 SHEET 1 OF 1