

FOCAL LENGTH (EFL): $15 \pm 0,15$
 BACK FOCAL LENGTH (BFL): 13,262

1 AR COATING: VIS 0°
 $R(\text{AVG}) \leq 0,4\%$ FROM 425-675nm @ 0° AOI

LEFT SURFACE		MATERIAL	RIGHT SURFACE	
R	$11,77 \pm 0,012$ CX	GLASS N-SF11 785/258	R	∞ PL
Øe	11,5		Øe	11,5
3/	3 (0,5) $\lambda=632,8$ nm		3/	3 (0,5) $\lambda=632,8$ nm
4/	-		4/	1,27'
5/	40 - 20 (MIL-PRF-13830B)		5/	40 - 20 (MIL-PRF-13830B)
6/	-		6/	-

PROTECTIVE CHAMFERS AS NEEDED

ROHS: COMPLIANT
 SCALE: NONE
 $\lambda = 587,6$ nm

SPECIFICATIONS SUBJECT TO CHANGE WITHOUT NOTICE. DIMENSIONS ARE FOR REFERENCE ONLY

FOR INFORMATION ONLY: DO NOT MANUFACTURE PARTS TO THIS DRAWING

INDICATIONS IN ACCORDANCE WITH ISO 10110

FIRST ANGLE PROJECTION

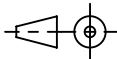

ALL DIMS IN: mm



Edmund Optics®

TITLE

12,5mm Dia, x 15,0mm FL, VIS 0 Coated, Plano-Convex Lens

DWG NO

38285

SHEET SIZE
A4

SHEET
1 OF 1