

FOCAL LENGTH (EFL):  $20 \pm 0,2$   
 BACK FOCAL LENGTH (BFL): 18,97

1 AR COATING: 633nm V-COAT  
 $R(\text{ABS}) < 0,25\% @ 633\text{nm} @ 0^\circ \text{AOI}$

LEFT SURFACE		MATERIAL	RIGHT SURFACE	
R	9,17±0,009 CX	GLASS FUSED SILICA 458/678	R	$\infty$ PL
Øe	4,5		Øe	4,5
3/	3 (0,5) $\lambda=632,8$ nm		3/	3 (0,5) $\lambda=632,8$ nm
4/	-		4/	2,18'
5/	40 - 20 (MIL-PRF-13830B)		5/	40 - 20 (MIL-PRF-13830B)
6/	-		6/	-

PROTECTIVE CHAMFERS AS NEEDED

ROHS: COMPLIANT    SCALE: NONE     $\lambda = 587,6\text{nm}$

SPECIFICATIONS SUBJECT TO CHANGE WITHOUT NOTICE. DIMENSIONS ARE FOR REFERENCE ONLY

FOR INFORMATION ONLY: DO NOT MANUFACTURE PARTS TO THIS DRAWING

INDICATIONS IN ACCORDANCE WITH ISO 10110

FIRST ANGLE PROJECTION

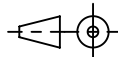

ALL DIMS IN: mm

**EO**® Edmund Optics®

TITLE 5mm Dia, x 20mm FL 633nm V-Coat, UV PCX Lens

DWG NO 34108

SHEET SIZE A4    SHEET 1 OF 1