

FOCAL LENGTH (EFL): 100 ± 1

BACK FOCAL LENGTH (BFL): 95,39

1 AR COATING: VIS 0°  
R(AVG) ≤ 0,4% FROM 425-675nm @ 0° AOI

LEFT SURFACE		MATERIAL	RIGHT SURFACE	
R	51,68±0,052 CX	GLASS N-BK7 517/642	R	∞ PL
Øe	39		Øe	39
3/	3 (0,5) λ=632,8 nm		3/	3 (0,5) λ=632,8 nm
4/	-		4/	1,93'
5/	40 - 20 (MIL-PRF-13830B)		5/	40 - 20 (MIL-PRF-13830B)
6/	-		6/	-

PROTECTIVE CHAMFERS AS NEEDED

ROHS: COMPLIANT    SCALE: NONE    λ = 587,6nm

SPECIFICATIONS SUBJECT TO CHANGE WITHOUT NOTICE. DIMENSIONS ARE FOR REFERENCE ONLY

FOR INFORMATION ONLY: DO NOT MANUFACTURE PARTS TO THIS DRAWING

INDICATIONS IN ACCORDANCE WITH ISO 10110

FIRST ANGLE PROJECTION

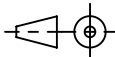

ALL DIMS IN: mm



Edmund Optics®

TITLE 40,0mm Dia, x 100,0mm FL, VIS 0 Coated, Plano-Convex Lens

DWG NO 33372

SHEET SIZE A4

SHEET 1 OF 1