

NOTES:

1. SUBSTRATE MATERIAL:  
BOROFLOAT®

2. COATING (APPLY ACROSS CLEAR APERTURE)

S1: UV Enhanced Aluminum  
R(avg) >89% @ 250 - 450nm  
R(avg) >85% @ 250 - 700nm  
DENSITY LIMIT: 0.5 J/cm<sup>2</sup> @ 355nm, 10ns  
S2: NONE

3. POWER, IRREGULARITY, SURFACE QUALITY, AND COATING SPECIFICATIONS APPLY ACROSS CLEAR APERTURE

△ FINE GROUND SURFACE

5. ROHS COMPLIANT

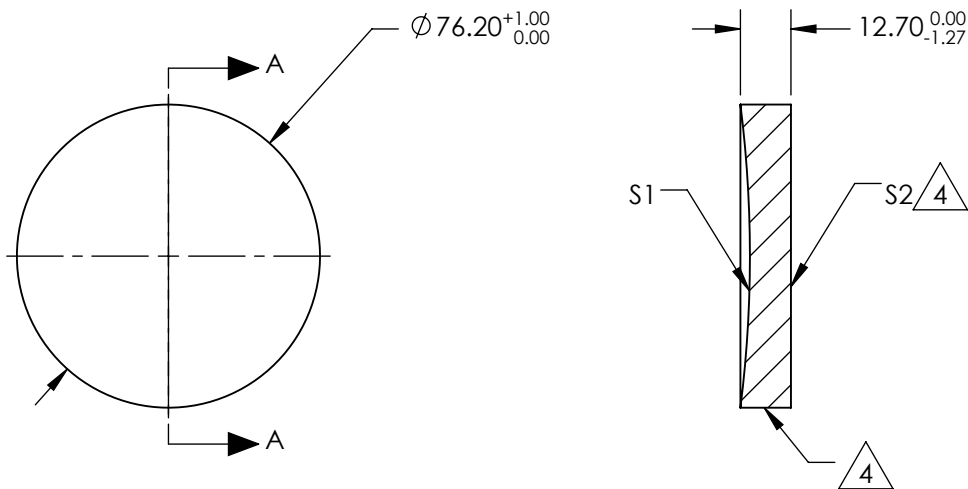

SECTION A-A

**FOR INFORMATION ONLY:  
DO NOT MANUFACTURE  
PARTS TO THIS DRAWING**

SPECIFICATIONS SUBJECT TO CHANGE WITHOUT NOTICE  
DIMENSIONS ARE FOR REFERENCE ONLY

| REV. A                 | S1                   | S2                   |
|------------------------|----------------------|----------------------|
| SHAPE                  | CONCAVE              | PLANO                |
| EFFECTIVE FOCAL LENGTH | 152.4mm              | N/A                  |
| FOCAL LENGTH TOLERANCE | ±2%                  | N/A                  |
| APERTURE               | f/2                  | N/A                  |
| SURFACE QUALITY        | 60-40                | 60-40                |
| SURFACE FLATNESS       | λ/4                  | λ/4                  |
| BEVEL                  | PROTECTIVE AS NEEDED | PROTECTIVE AS NEEDED |

THIRD ANGLE PROJECTION

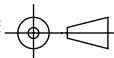

ALL DIMS IN

mm

**EO**® **Edmund Optics**®

TITLE

Ø3in, 6in FL UV ENHANCED ALIUMINUM,  
SPHERICAL MIRROR

DWG NO

43555

SHEET  
1 OF 1