

NOTES:

- 1. SUBSTRATE MATERIAL: N-BK7
- 2. ROHS COMPLIANT
- 3. COATING (APPLY ACROSS CLEAR APERTURE)
 S1 & S2: R(avg) >85% @ 400 - 700nm W/BLACK OVERPAINT
 S3 & S4: R(avg) ≤1.75% @ 400 - 700nm
 S5: BLACK PAINT

4. FINE GRIND SURFACE

**FOR INFORMATION ONLY:
DO NOT MANUFACTURE
PARTS TO THIS DRAWING**

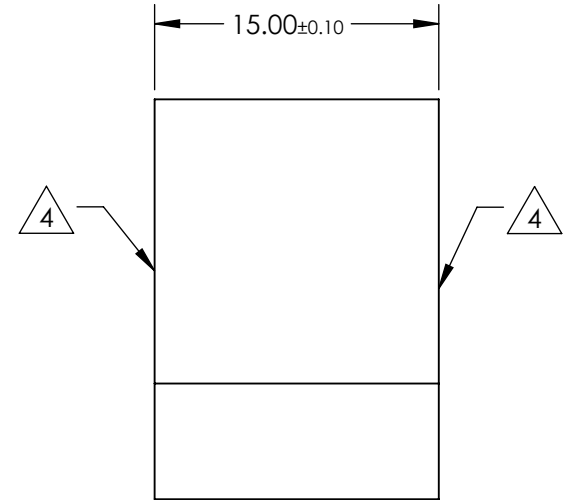
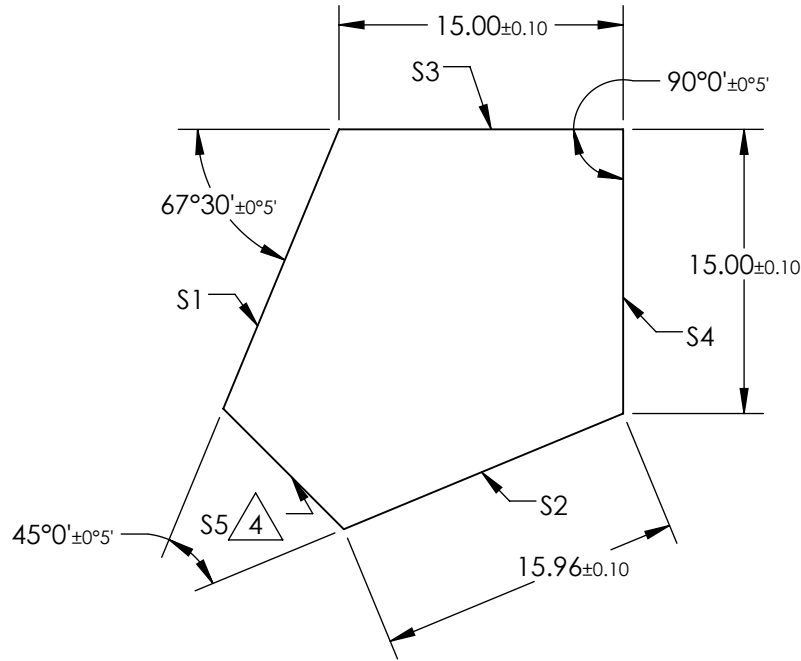

SPECIFICATIONS SUBJECT TO CHANGE WITHOUT NOTICE
DIMENSIONS ARE FOR REFERENCE ONLY

| REV. A | S1 | S2 |
|------------------|----------------------|----------------------|
| SHAPE | PLANO | PLANO |
| ANGLE TOL. | ±5 arcmin | ±5 arcmin |
| SURFACE QUALITY | 60-40 | 60-40 |
| SURFACE FLATNESS | λ/4 | λ/4 |
| BEVEL | PROTECTIVE AS NEEDED | PROTECTIVE AS NEEDED |

THIRD ANGLE PROJECTION

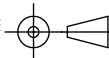

ALL DIMS IN

mm

EO® Edmund Optics®

TITLE

15mm, MgF2 COATED, PENTA PRISM

DWG NO

43502

SHEET
1 OF 1