

NOTES:

1. SUBSTRATE MATERIAL:  
BOROFLOAT®

2. COATING (APPLY ACROSS CLEAR APERTURE)

S1: Protected Aluminum  
 R(avg) >85% @ 400 - 700nm  
 R(avg) >90% @ 400 - 2000nm  
 DENSITY LIMIT: 0.3 J/cm² @ 532nm & 1064nm, 10ns  
 S2: NONE

3. POWER, IRREGULARITY, SURFACE QUALITY, AND COATING SPECIFICATIONS APPLY ACROSS CLEAR APERTURE

△ 4. FINE GROUND SURFACE

5. ROHS COMPLIANT

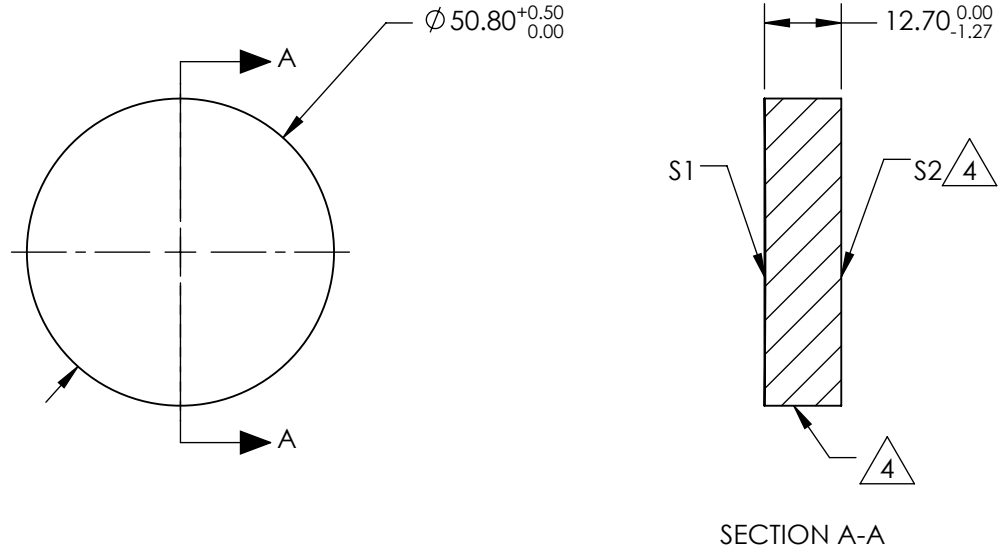

**FOR INFORMATION ONLY:  
DO NOT MANUFACTURE  
PARTS TO THIS DRAWING**

SPECIFICATIONS SUBJECT TO CHANGE WITHOUT NOTICE  
DIMENSIONS ARE FOR REFERENCE ONLY

REV. A	S1	S2
SHAPE	CONCAVE	PLANO
EFFECTIVE FOCAL LENGTH	1016mm	N/A
FOCAL LENGTH TOLERANCE	±2%	N/A
APERTURE	f/20	N/A
SURFACE QUALITY	60-40	60-40
SURFACE FLATNESS	λ/4	λ/4
BEVEL	PROTECTIVE AS NEEDED	PROTECTIVE AS NEEDED

THIRD ANGLE PROJECTION

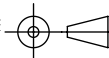

ALL DIMS IN

mm

**EO**® Edmund Optics®

TITLE

2" Dia, 40" FL Protected Alum., Spherical Mirror

DWG NO

43348

SHEET  
1 OF 1