

NOTES:

1. SUBSTRATE MATERIAL:
BOROFLOAT®

2. COATING (APPLY ACROSS CLEAR APERTURE)

S1: PROTECTED GOLD

R(avg) >96% @ 700 - 2000

R(avg) >96% @ 2000 - 10000nm

DENSITY LIMIT: 0.8 J/cm² @ 1064nm, 10ns

S2: NONE

3. POWER, IRREGULARITY, SURFACE QUALITY, AND COATING SPECIFICATIONS APPLY ACROSS CLEAR APERTURE

△ FINE GROUND SURFACE

5. ROHS COMPLIANT

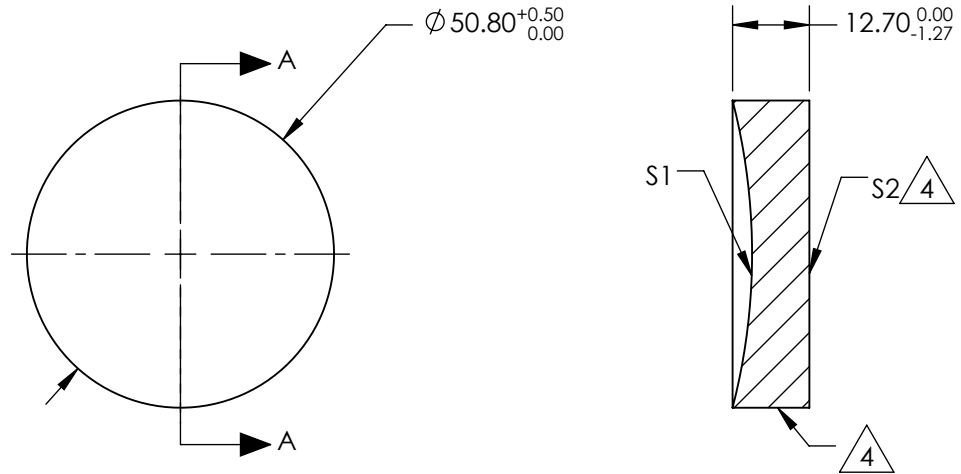

SECTION A-A

**FOR INFORMATION ONLY:
DO NOT MANUFACTURE
PARTS TO THIS DRAWING**

SPECIFICATIONS SUBJECT TO CHANGE WITHOUT NOTICE
DIMENSIONS ARE FOR REFERENCE ONLY

| REV. A | S1 | S2 |
|------------------------|----------------------|----------------------|
| SHAPE | CONCAVE | PLANO |
| EFFECTIVE FOCAL LENGTH | 50.8mm | N/A |
| FOCAL LENGTH TOLERANCE | ±2% | N/A |
| APERTURE | f/1 | N/A |
| SURFACE QUALITY | 60-40 | 60-40 |
| SURFACE FLATNESS | λ/4 | λ/4 |
| BEVEL | PROTECTIVE AS NEEDED | PROTECTIVE AS NEEDED |

THIRD ANGLE PROJECTION

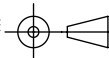

ALL DIMS IN

mm



| TITLE | DWG NO | SHEET |
|---|--------|--------|
| Ø2in, 2in FL PROTECTED GOLD, SPHERICAL MIRROR | 32813 | 1 OF 1 |