

NOTES:

1. SUBSTRATE
  2. SURFACE S2 TO BE PARALLEL WITH SURFACE S1 TO WITHIN 5 arcsec
  3. COATING (APPLY ACROSS COATING APERTURE)  
 ENVIRONMENTAL DURABILITY:  
 PHYSICAL DURABILITY:  
 PERFORMANCE SPECIFICATIONS:  
 T(avg): >85% FROM 400 - 630nm FOR RANDOM POLARIZATION @ 45° AOI  
 T(abs): >80% FROM 400 - 630nm FOR ALL POLARIZATIONS @ 45° AOI  
 R(avg): >97% FROM 675 - 850nm FOR RANDOM POLARIZATION @ 45° AOI  
 R(abs): >95% FROM 675 - 850nm FOR ALL POLARIZATIONS @ 45° AOI  
 T(abs): = 50% 650nm @ 45° AOI
- S1: HARD COATED  
 S2: SINGLE LAYER MgF2

FOR INFORMATION ONLY:  
 DO NOT MANUFACTURE  
 PARTS TO THIS DRAWING

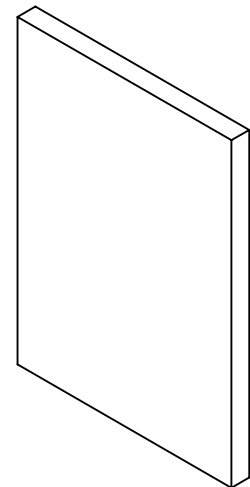

4. FINE GRIND SURFACE

5. POWER, IRREGULARITY, AND SURFACE QUALITY SPECIFICATIONS  
 APPLY ACROSS CLEAR APERTURE
6. TRANSMITTED WAVEFRONT DISTORTION RMS@ 632.8nm  $\leq \frac{1}{4} \lambda$
7. ROHS COMPLIANT

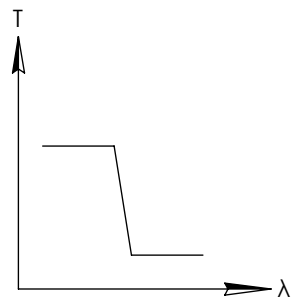
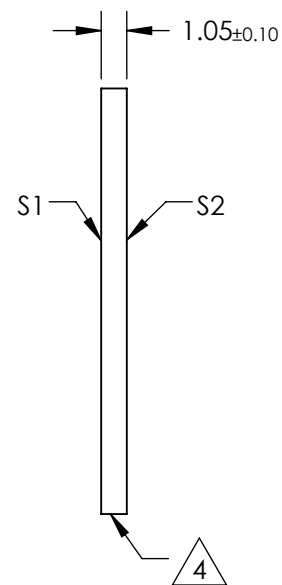
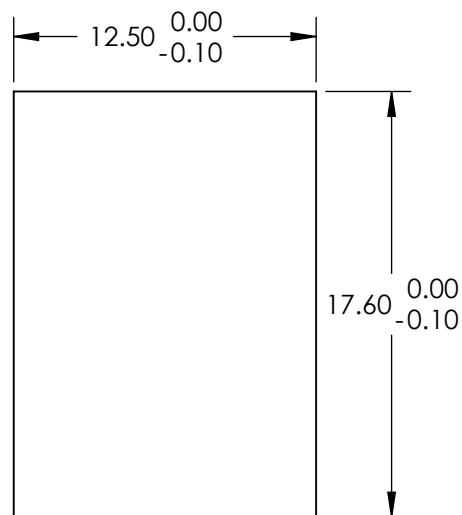

SHORTPASS FILTER

SPECIFICATIONS SUBJECT TO CHANGE WITHOUT NOTICE  
 DIMENSIONS ARE FOR REFERENCE ONLY

	S1	S2
SHAPE	PLANO	PLANO
SURFACE QUALITY	60-40	60-40
CLEAR APERTURE	11.0 x 16.0	11.0 x 16.0
BEVEL	PROTECTIVE AS NEEDED	PROTECTIVE AS NEEDED

**EO**® Edmund Optics®

THIRD ANGLE PROJECTION

ALL DIMS IN mm

TITLE	12.5 x 17.6mm, 650nm DICHROIC SHORTPASS FILTER
DWG NO	69193
SHEET	1 OF 1