

NOTES:

1. SUBSTRATE:
BOROFLOAT®
2. COATING SPECIFICATION:
S1: Protected Aluminum (400-2000nm)
R(AVG) >85% @ 400 - 700nm
R(AVG) >90% @ 400 - 2000nm

3. FINE GROUND SURFACE

4. ROHS COMPLIANT

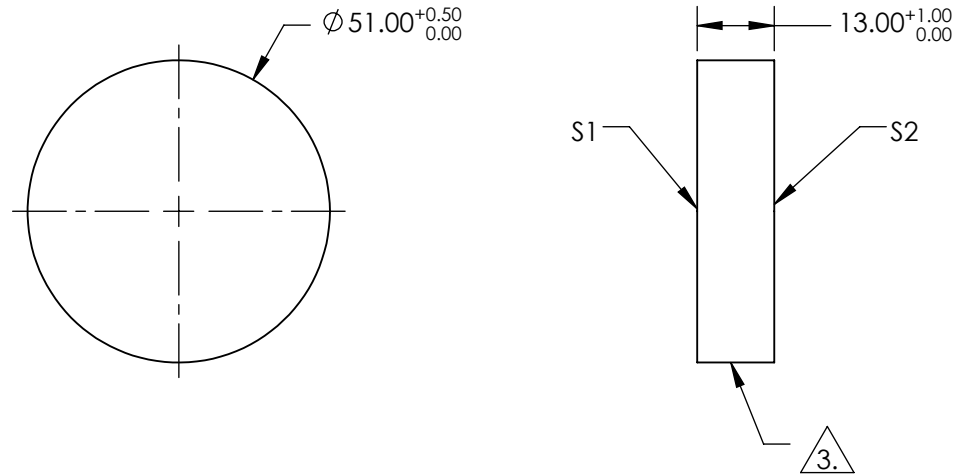
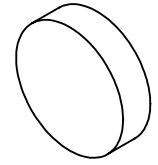

**FOR INFORMATION ONLY:
DO NOT MANUFACTURE
PARTS TO THIS DRAWING**

SPECIFICATIONS SUBJECT TO CHANGE WITHOUT NOTICE
DIMENSIONS ARE FOR REFERENCE ONLY

	S1	S2
SHAPE	PLANO	PLANO
SURFACE QUALITY	60-40	COMMERCIAL POLISH
CLEAR APERTURE	$\varnothing 49.09$	N/A
BEVEL	PROTECTIVE AS NEEDED	PROTECTIVE AS NEEDED



ALL DIMS IN

mm

EO® Edmund Optics®

TITLE

51mm Dia. Protected Aluminum, $\lambda/4$ Mirror

DWG NO

33511

SHEET
1 OF 1